

Newton Centre

Existing Zoning

- Business (BU)
- Manufacturing (LM, M)
- Multi-Residence (MR)
- Single Residence (SR)
- Mixed Use (MU)
- Public Use & Open Space (PU, OS/R)

Proposed Zoning

- Village Center 3 (VC3)
- Village Center 2 (VC2)
- Multi-Residence Transit (MRT)
- Mixed-Use Required
- Historic District
- MBTA Buffer

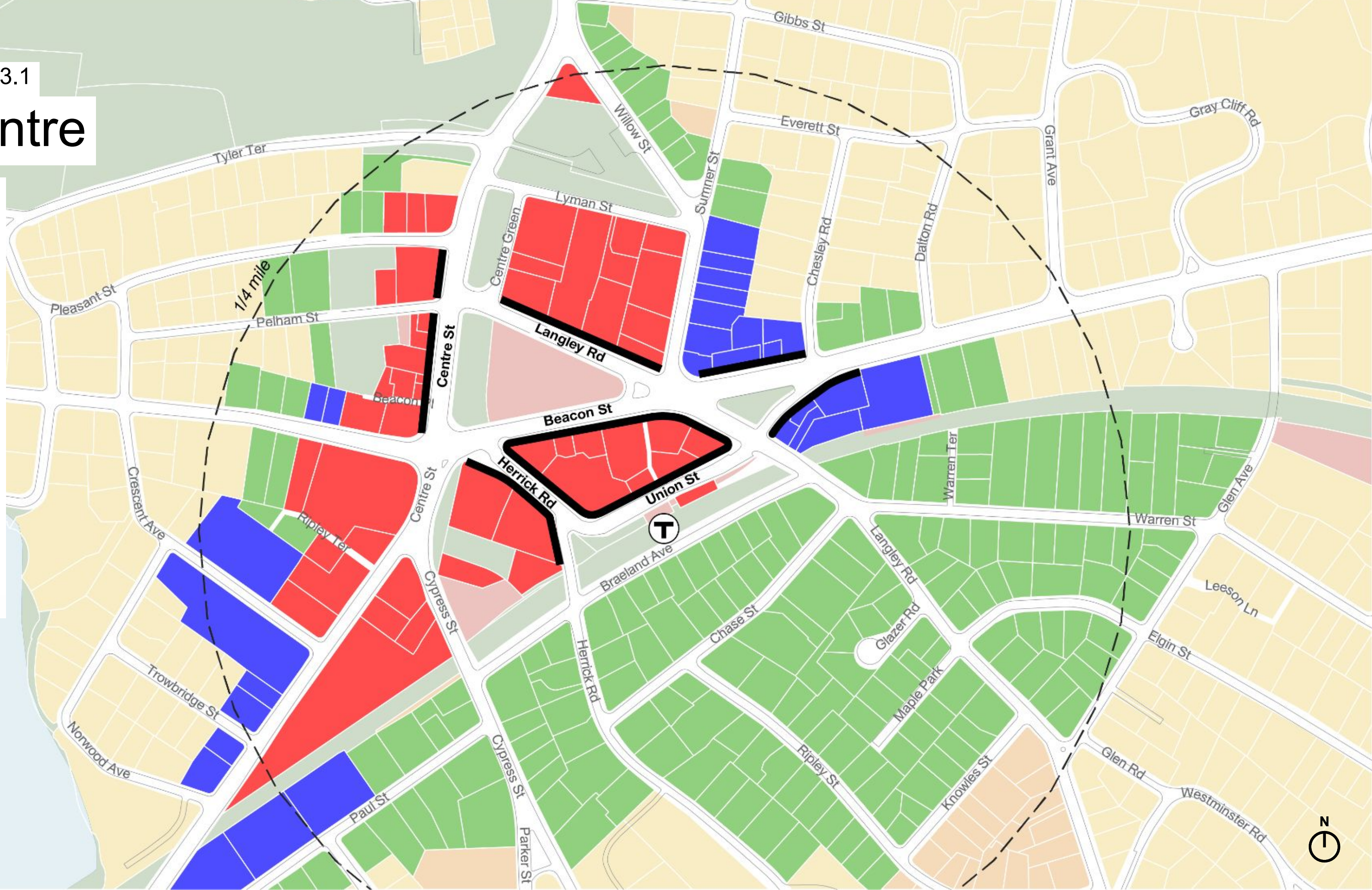

Village Centers - Version 3.1

Auburndale

Existing Zoning

- Business (BU)
- Manufacturing (LM, M)
- Multi-Residence (MR)
- Single Residence (SR)
- Mixed Use (MU)
- Public Use & Open Space (PU, OS/R)

Proposed Zoning

- Village Center 3 (VC3)
- Village Center 2 (VC2)
- Multi-Residence Transit (MRT)
- Mixed-Use Required
- Historic District
- MBTA Buffer

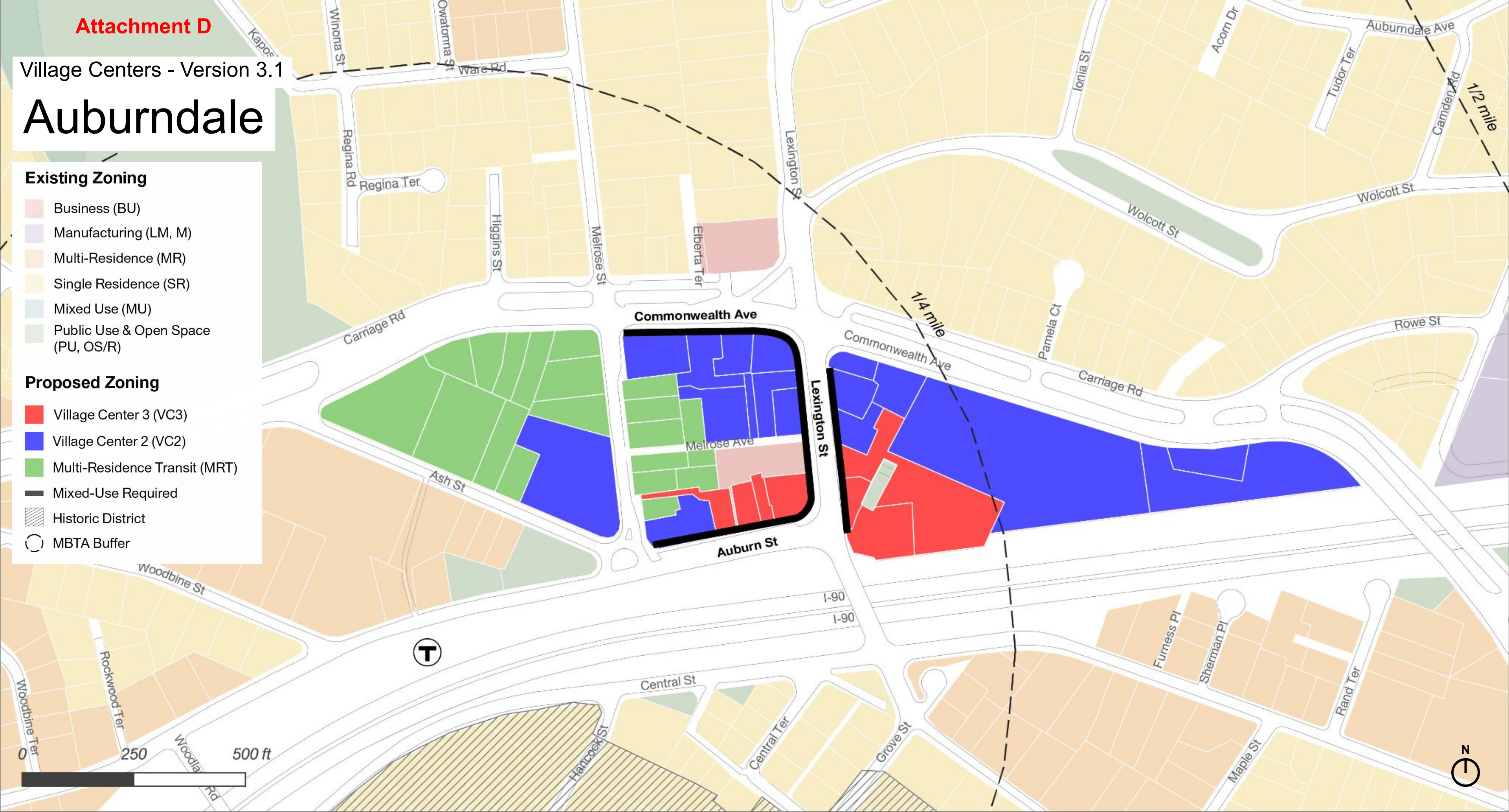

West Newton

Existing Zoning

- Business (BU)
- Manufacturing (LM, M)
- Multi-Residence (MR)
- Single Residence (SR)
- Mixed Use (MU)
- Public Use & Open Space (PU, OS/R)

Proposed Zoning

- Village Center 3 (VC3)
- Village Center 2 (VC2)
- Multi-Residence Transit (MRT)
- Mixed-Use Required
- Historic District
- MBTA Buffer

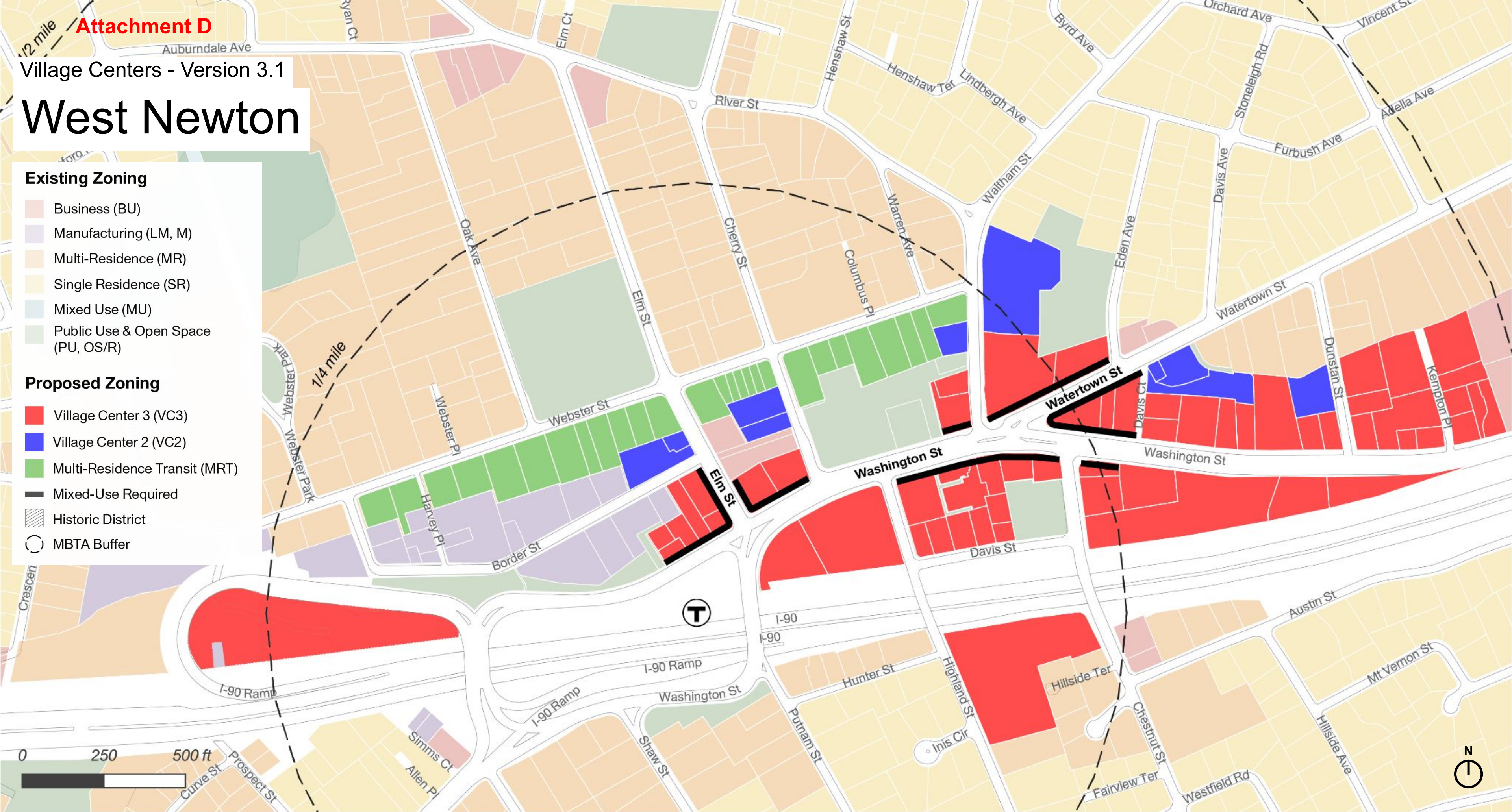

Village Centers - Version 3.1

Newtonville

Existing Zoning

- Business (BU)
- Manufacturing (LM, M)
- Multi-Residence (MR)
- Single Residence (SR)
- Mixed Use (MU)
- Public Use & Open Space (PU, OS/R)

Proposed Zoning

- Village Center 3 (VC3)
- Village Center 2 (VC2)
- Multi-Residence Transit (MRT)
- Mixed-Use Required
- Historic District
- MBTA Buffer



Village Centers - Version 3.1

Nonantum

Existing Zoning

- Business (BU)
- Manufacturing (LM, M)
- Multi-Residence (MR)
- Single Residence (SR)
- Mixed Use (MU)
- Public Use & Open Space (PU, OS/R)

Proposed Zoning

- Village Center 3 (VC3)
- Village Center 2 (VC2)
- Multi-Residence Transit (MRT)
- Mixed-Use Required
- Historic District
- MBTA Buffer

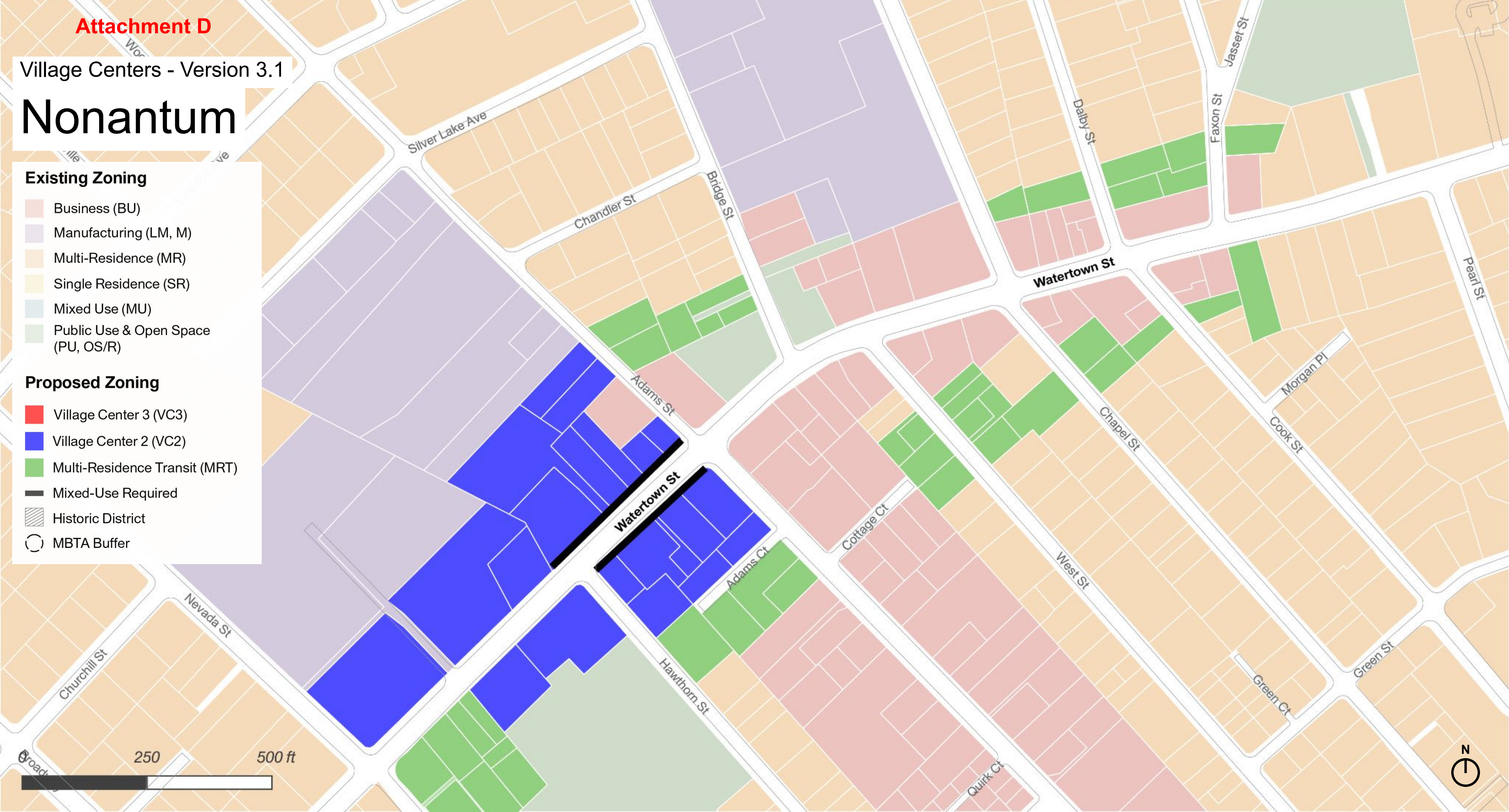







Newton Corner

Existing Zoning

-  Business (BU)
-  Manufacturing (LM, M)
-  Multi-Residence (MR)
-  Single Residence (SR)
-  Mixed Use (MU)
-  Public Use & Open Space (PU, OS/R)

Proposed Zoning

-  Village Center 3 (VC3)
-  Village Center 2 (VC2)
-  Multi-Residence Transit (MRT)
-  Mixed-Use Required
-  Historic District
-  MBTA Buffer

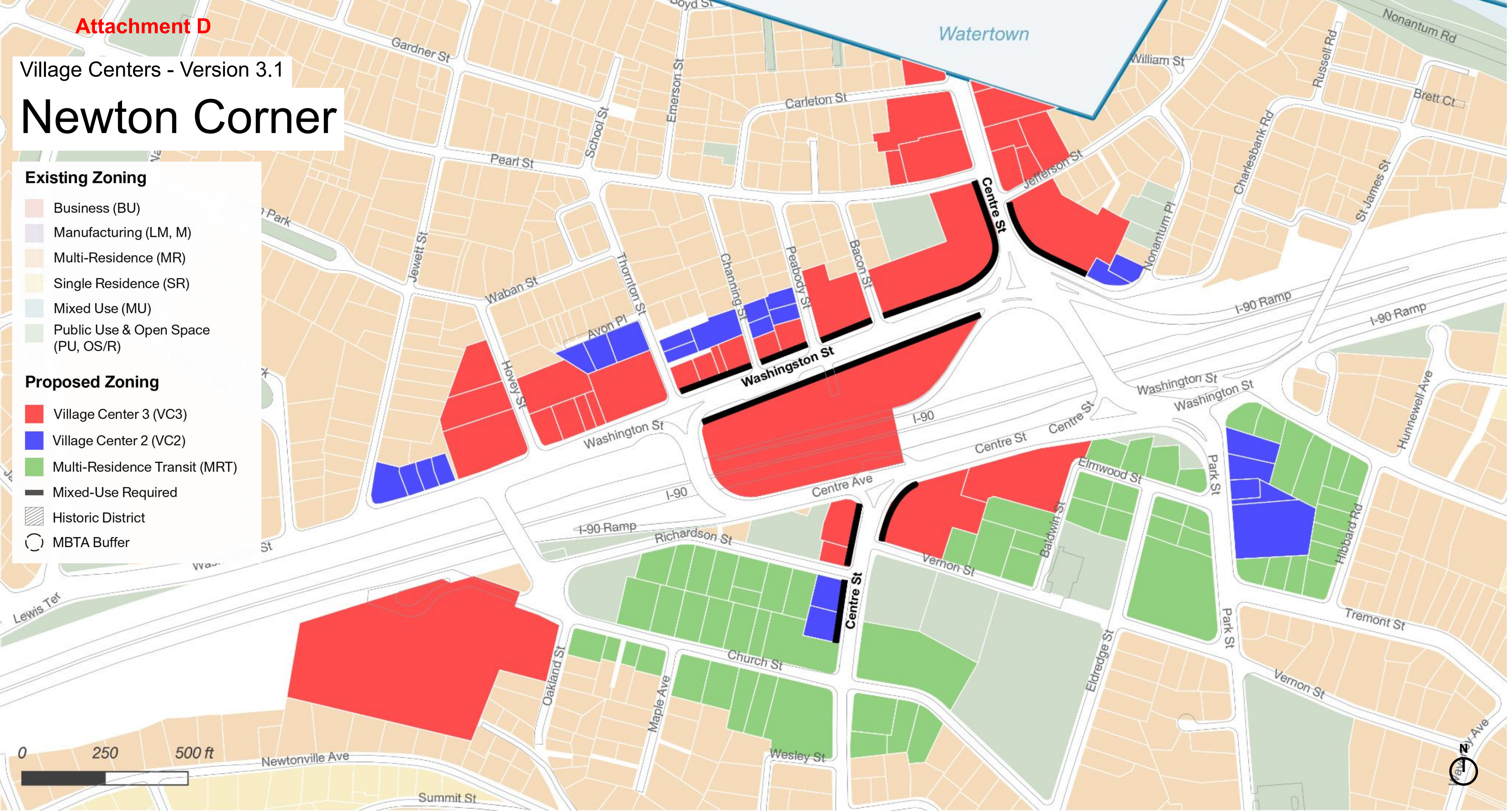

Newton Lower Falls

Existing Zoning

- Business (BU)
- Manufacturing (LM, M)
- Multi-Residence (MR)
- Single Residence (SR)
- Mixed Use (MU)
- Public Use & Open Space (PU, OS/R)

Proposed Zoning

- Village Center 3 (VC3)
- Village Center 2 (VC2)
- Multi-Residence Transit (MRT)
- Mixed-Use Required
- Historic District
- MBTA Buffer



Waban

Existing Zoning

- Business (BU)
- Manufacturing (LM, M)
- Multi-Residence (MR)
- Single Residence (SR)
- Mixed Use (MU)
- Public Use & Open Space (PU, OS/R)

Proposed Zoning

- Village Center 3 (VC3)
- Village Center 2 (VC2)
- Multi-Residence Transit (MRT)
- Mixed-Use Required
- Historic District
- MBTA Buffer

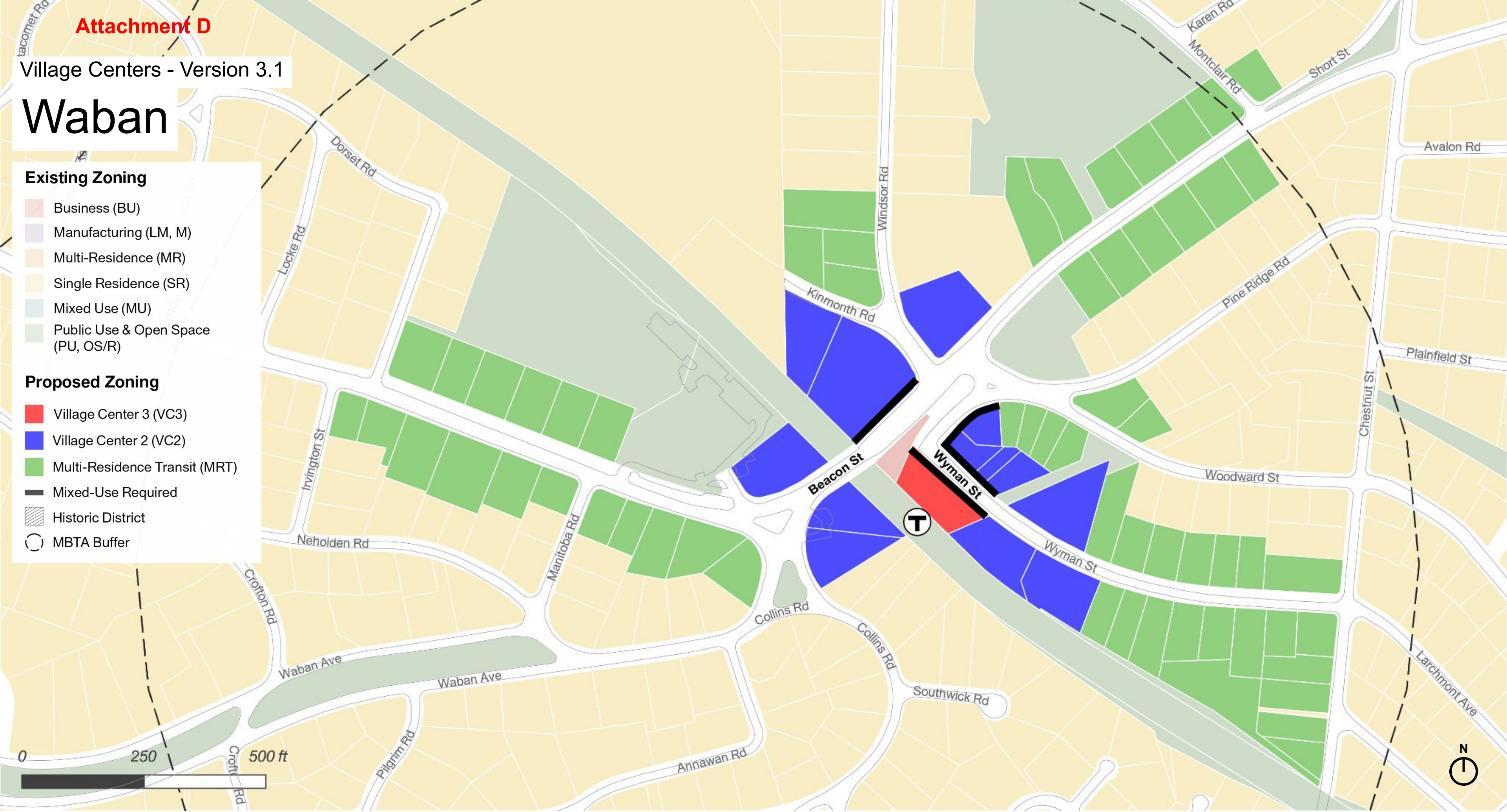

Village Centers - Version 3.1

Four Corners

Existing Zoning

- Business (BU)
- Manufacturing (LM, M)
- Multi-Residence (MR)
- Single Residence (SR)
- Mixed Use (MU)
- Public Use & Open Space (PU, OS/R)

Proposed Zoning

- Village Center 3 (VC3)
- Village Center 2 (VC2)
- Multi-Residence Transit (MRT)
- Mixed-Use Required
- Historic District
- MBTA Buffer

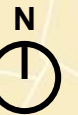
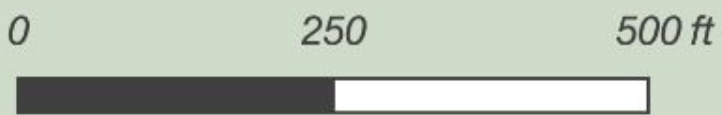

Upper Falls (Pettee Square)

Existing Zoning

- Business (BU)
- Manufacturing (LM, M)
- Multi-Residence (MR)
- Single Residence (SR)
- Mixed Use (MU)
- Public Use & Open Space (PU, OS/R)

Proposed Zoning

- Village Center 3 (VC3)
- Village Center 2 (VC2)
- Multi-Residence Transit (MRT)
- Mixed-Use Required
- Historic District
- MBTA Buffer

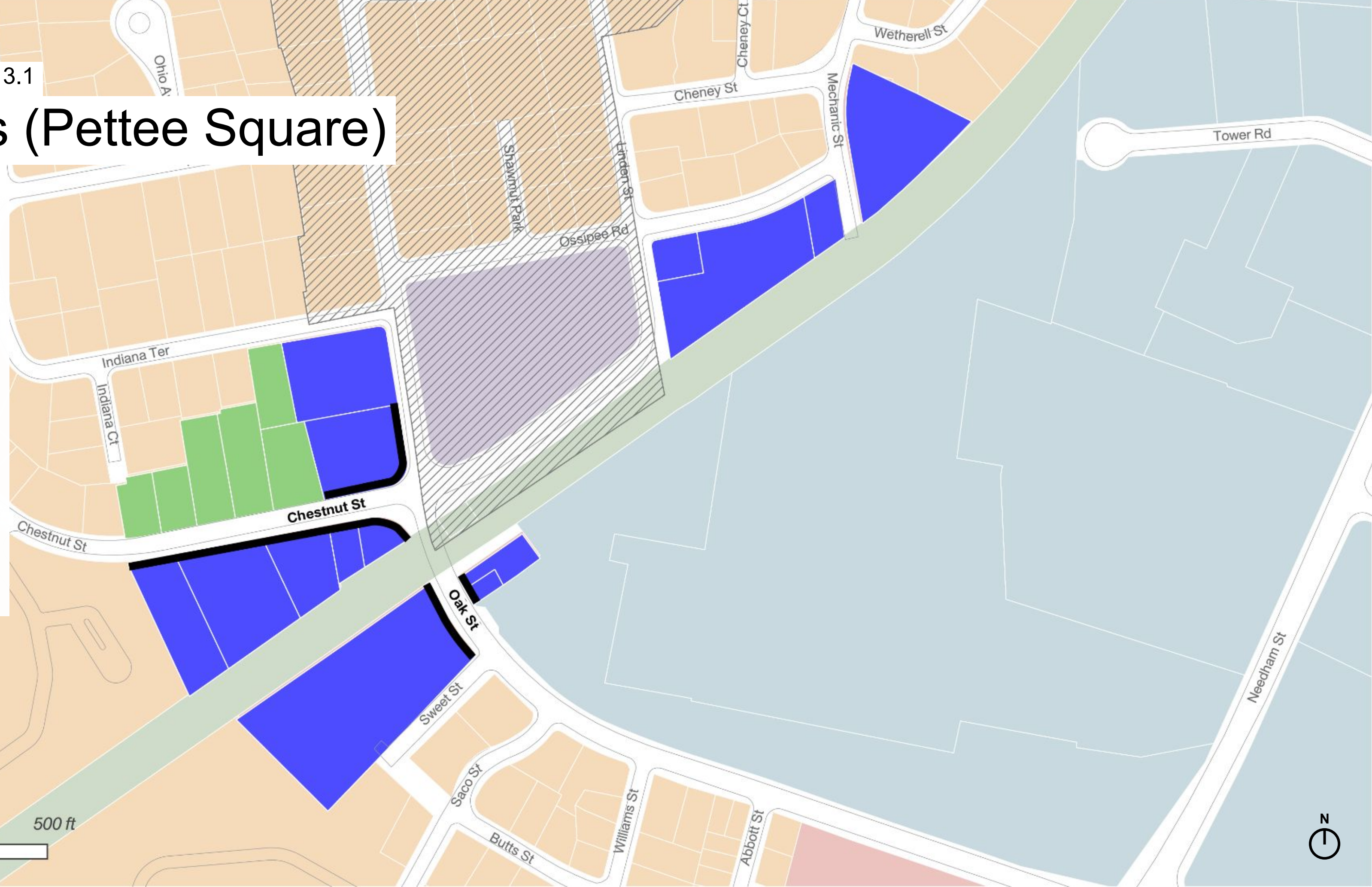

Thompsonville

Existing Zoning

- Business (BU)
- Manufacturing (LM, M)
- Multi-Residence (MR)
- Single Residence (SR)
- Mixed Use (MU)
- Public Use & Open Space (PU, OS/R)

Proposed Zoning

- Village Center 3 (VC3)
- Village Center 2 (VC2)
- Multi-Residence Transit (MRT)
- Mixed-Use Required
- Historic District
- MBTA Buffer

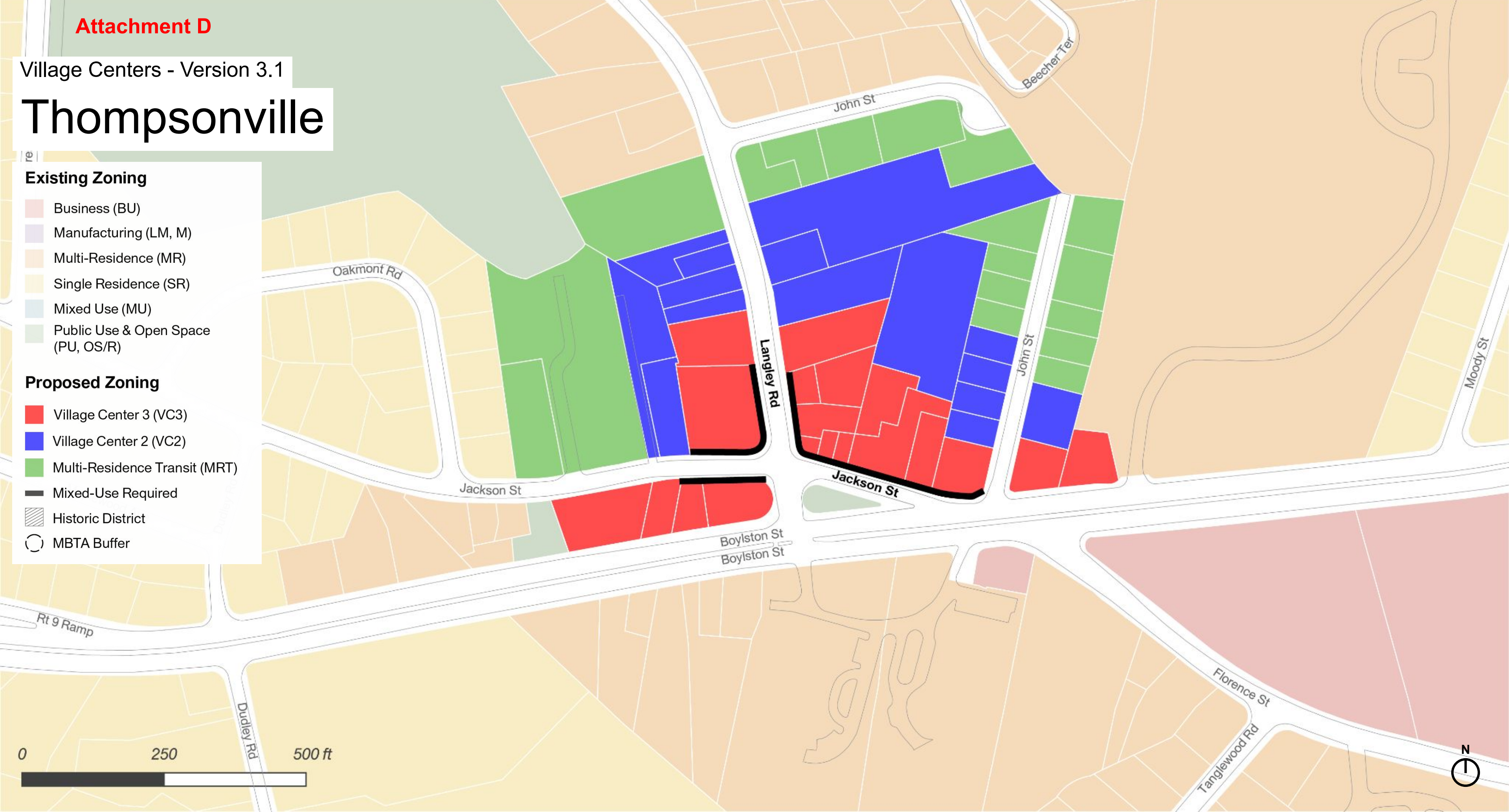

Newton Highlands

Existing Zoning

- Business (BU)
- Manufacturing (LM, M)
- Multi-Residence (MR)
- Single Residence (SR)
- Mixed Use (MU)
- Public Use & Open Space (PU, OS/R)

Proposed Zoning

- Village Center 3 (VC3)
- Village Center 2 (VC2)
- Multi-Residence Transit (MRT)
- Mixed-Use Required
- Historic District
- MBTA Buffer

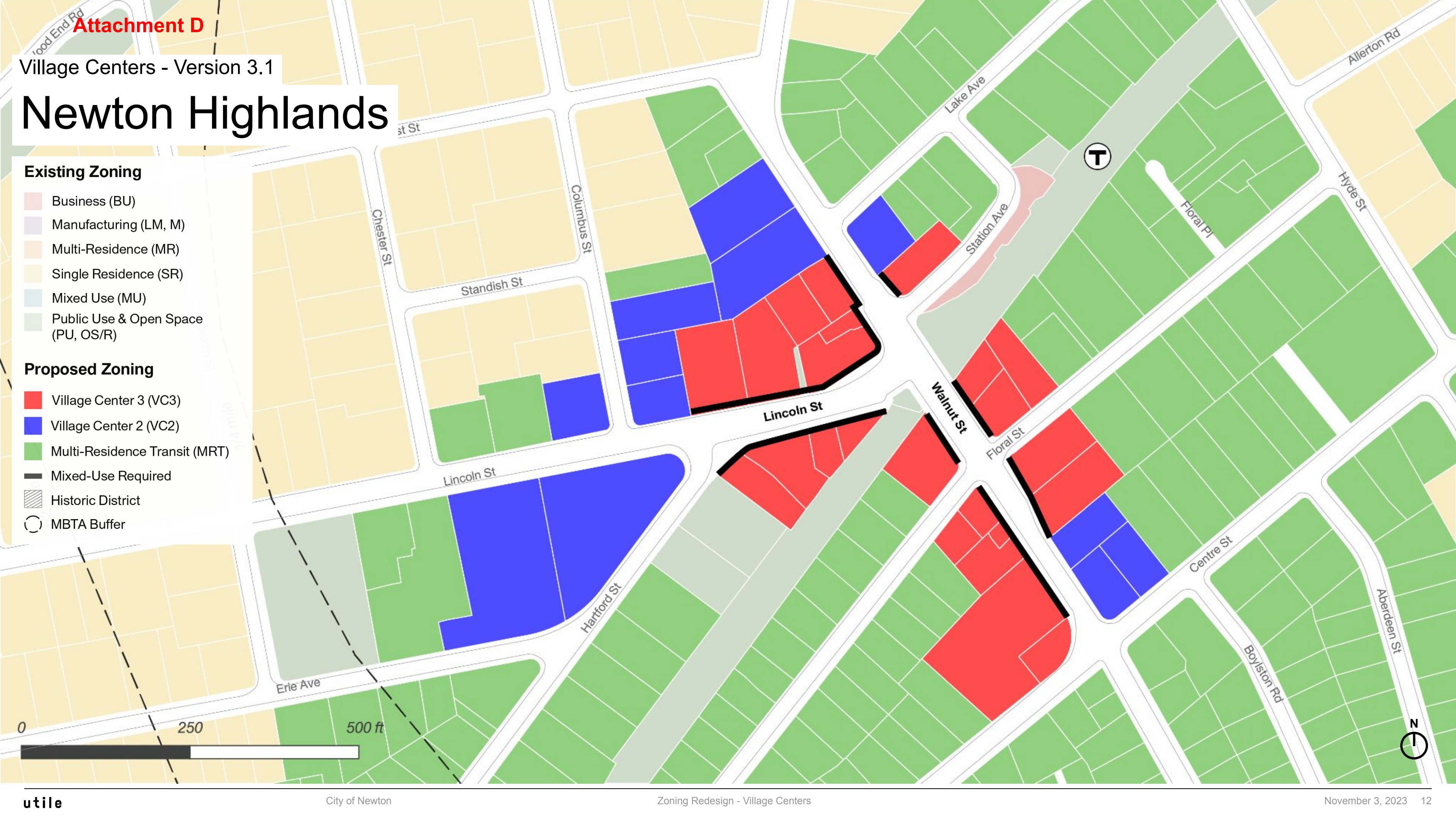

Eliot T Stop

Existing Zoning

- Business (BU)
- Manufacturing (LM, M)
- Multi-Residence (MR)
- Single Residence (SR)
- Mixed Use (MU)
- Public Use & Open Space (PU, OS/R)

Proposed Zoning

- Village Center 3 (VC3)
- Village Center 2 (VC2)
- Multi-Residence Transit (MRT)
- Mixed-Use Required
- Historic District
- T MBTA Buffer

