

FIRST FLOOR ROOMS



BRUCE ROOM

The Bruce room offers flexible floor plans set up with a variety of options for dining, meetings and instructional sessions. This architecturally designed room features beautiful stone walls and six sunburst windows.

Dimensions 31'4" x 29' 10" - 914 Sq Ft



TYLER ROOM

Joined to the Bruce Room by French doors, this beautiful oak paneled room boasts exquisite wood carvings and high molded ceilings. Appointed with an elegant gas fireplace. Arranged to meet your dining or meeting specifications

Dimensions 17' x 16' 8" - 286 Sq Ft



CAREY ROOM

A bright large multi-functional room featuring a gas fireplace and a glistening hardwood dance floor. The Carey Room can be designed to be set up for various activities including auditorium style, classroom or dining.

Dimensions 39' 6"x 21' 3" - 843 Sq Ft

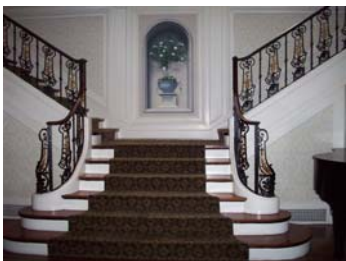

RECEPTION HALLWAY

Featuring the Grand Staircase leading from the upper balcony down to the baby grand piano. A perfect setting for ceremonies, speeches and toasts. A welcoming gathering area for guests to enjoy cocktails and hors d'oeuvres.

Dimensions 31' 9"x 26' 9" - 858 Sq Ft



MOCK ROOM

A versatile room set up to meet your specific needs. Often used for beverage service or coffee breaks. Featuring a hand painted ceiling and gas fireplace with French doors leading out to the patio.

Dimensions 17'x 16' 8" - 858 Sq Ft

SECOND FLOOR ROOMS



KERR ROOM

A large room that features a fireplace and high sculptured ceiling with a dramatic hand painted mural. Whether you seek a professional meeting arrangement, a classroom environment or a dining room set up, our staff is dedicated to arranging the room to fit all your professional or casual needs.

Dimensions 29'10" x 18' 3" - 533 Sq Ft



SIMONDS ROOM

A cozy room on the second floor featuring hardwood floors and a fireplace. Often used as a break out room, intimate dining room or a children's room.

Dimensions 15' x 15' - 225 Sq Ft



CHANNING ROOM

Decorated in cream and blue faux painted walls, this beautiful room is often used as our bridal room. The Channing room can also be designed to host seminars, classrooms and dining.

Dimensions 25' 10"x 18' 3" - 452 Sq Ft



JONES ROOM

Decorated in a presidential theme, this room features a gas-lit fireplace making it a cozy retreat for discussion and thoughtful conversations.

Dimensions 16'x 15' - 240 Sq Ft



CROCKETT ROOM

This lovely room features hand carved period detail with gold leaf and a gas lit fireplace. The Crockett room has an adjoining galley kitchen set up with refreshments available throughout your meeting.

Dimensions 20'x 23 - 460 Sq Ft

ROOM CAPACITIES

The capacity for events held at the Henderson House will depend on how many rooms in the mansion you use, the style of set up and AV needs and whether or not you need to be in one room. Please note that the capacities listed are approximations. Your event coordinator will help customize your set up based on your guest count and needs.

The Maximum capacity is 200 guests. This is achieved by utilizing rooms for dining on both the first and second floors.

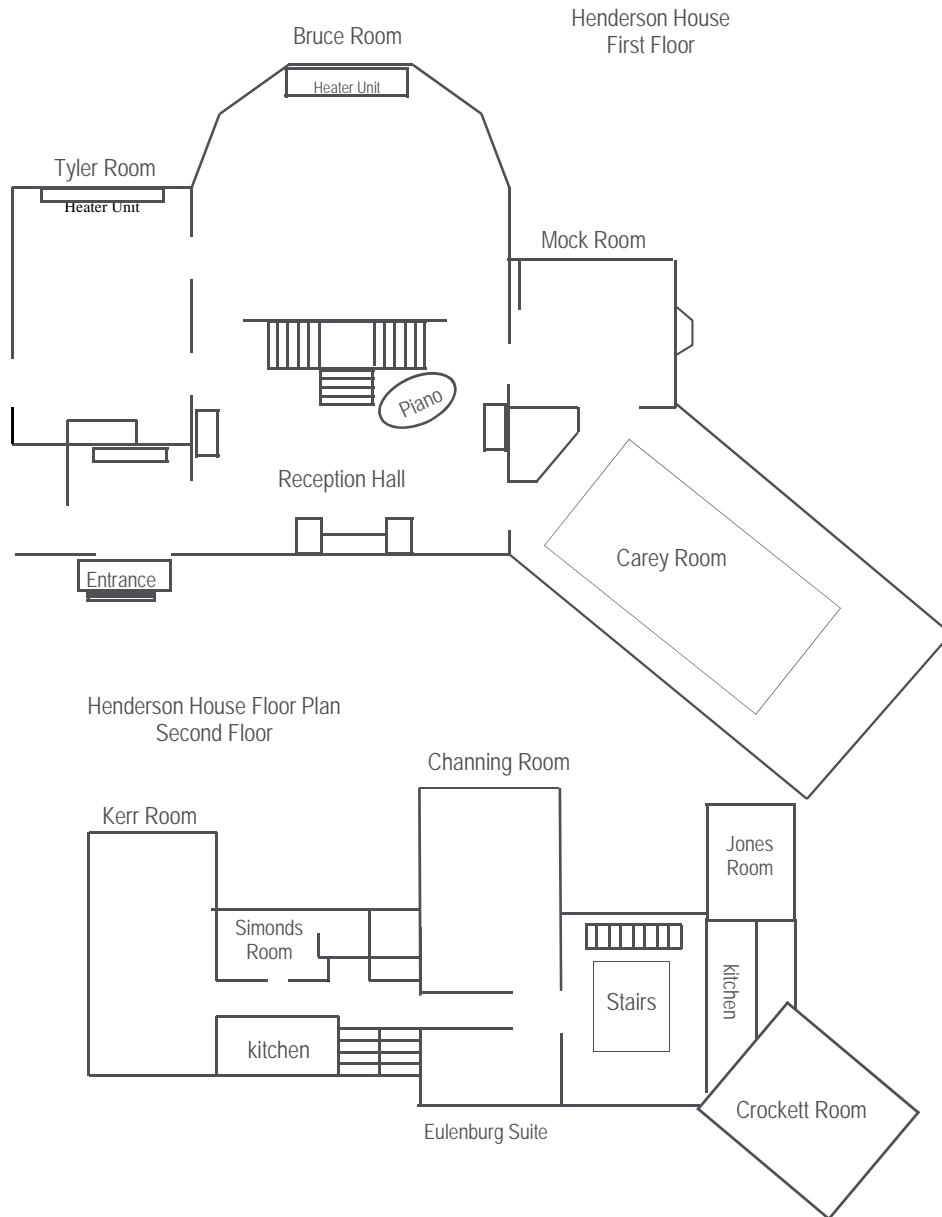

FIRST FLOOR

*Indicates inside & outside seating

| Room | Theater Style | Class Room | Board Room | U Shape | Banquet Rounds | Hollow Square |
|------------|---------------|------------|------------|---------|----------------|---------------|
| Bruce Room | 75 | 45 | 24 | 30-45* | 80 | 36 |
| Mock Room | N/A | N/A | 12 | N/A | 16 | N/A |
| Tyler Room | N/A | 12 | 16 | 15 | 32 | 24 |
| Carey Room | 110 | 52 | 36 | 30-45* | 64 | 36 |

SECOND FLOOR

| Room | Theater Style | Class Room | Board Room | U Shape | Banquet Rounds | Hollow Square |
|---------------|---------------|------------|------------|---------|----------------|---------------|
| Kerr Room | 40 | 24 | 18 | 24 | 50 | 30 |
| Simonds Room | N/A | N/A | 10 | N/A | 12 | N/A |
| Channing Room | 40 | 24 | 18 | 21 | 40 | 30 |
| Jones Room | N/A | N/A | N/A | N/A | 12 | N/A |
| Crockett Room | 40 | 21 | 16 | 18 | 32 | 21 |

THIRD FLOOR (Diagram not shown)

| Room | Dimensions | Square Feet | Board Room Only |
|------------------|-----------------|-------------|-----------------|
| Huntington Suite | 16' 6" x 12' 3" | 204 | 10 |
| Morrison Suite | 18' 4" x 14' 9" | 274 | 12 |
| Corner Suite | 15' x 11' 3" | 169 | 10 |



THE PATIO

The patio adjacent to the Henderson House is an attractive location for outside activity to enhance your event. Featuring a water fountain it is the perfect spot for a barbecue, pre-dinner hors d'oeuvres or wedding ceremony. 2000 Sq Ft

Contact us

The Henderson House, 99 West Cliff Road Weston, MA 02493

Rob Kirkpatrick ~ General Manager
(t) 781-235-8517 ~ (f) 781-235-5847
email r.kirkpatrick@neu.edu

Lisa Giles ~ Food & Beverage Director
(t) 781-235-4314
email l.giles@neu.edu